

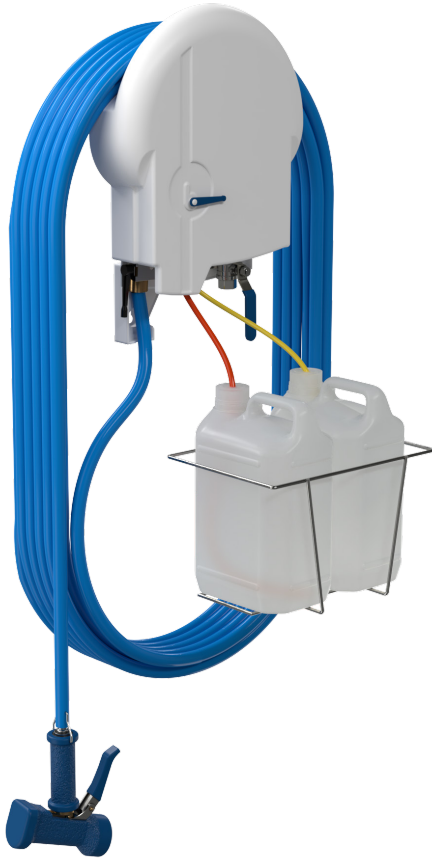

EcoSpray Station - 1 or 2 Chemicals

Product Datasheet



Description

Our EcoSpray system for cleaning and disinfecting large areas is designed with convenience and safety in mind. The spray gun provides targeted and widespread coverage. The two chemical model is ideal for cleaning environments with both detergent and sanitizer.

Key Features

- Robust and ergonomic design
- Durable components with high chemical compatibility
- Built-in backflow prevention system
- Protective cover keeps the system clean and contamination-free
- Integrated hose rack with the option of being wall mounted or assembled with a cart
- Available with 33' or 50' hose
- Customer branding options available
- Also available in a stainless steel version
- Optional foam wand attachment produces rich foam to increase chemical contact time
- Optional spray lances for improved accuracy and reach

Technical Specifications

Operation	Spray gun with locking trigger
Installation	Requires mains water connection Minimum water pressure: 22 PSI Maximum water pressure: 116 PSI Max. suction height 5' 5"
Dilution	Dilution ratio is selected with supplied metering tips ranging from 6:1 to 400:1
Water Temperature	Up to 130°F
Material	Polypropylene housing, PVDF venturi body

In the Box

EcoSpray Station	Hose (33' or 50')
5' Inlet Hose (½" stainless steel braided)	Wall bracket for chemical container
EcoSpray gun	Chemical suction tube
Installation kit (metering tips, fixings and chemical connections)	

T (+1) 913-956-4909 **E** sales@brightwell-inc.com **W** brightwell-inc.com

Brightwell Dispensers Inc. 9858 Britton Street, Lenexa, KS, 66219

All information in this data sheet is correct at the time of printing and is subject to change without notice.

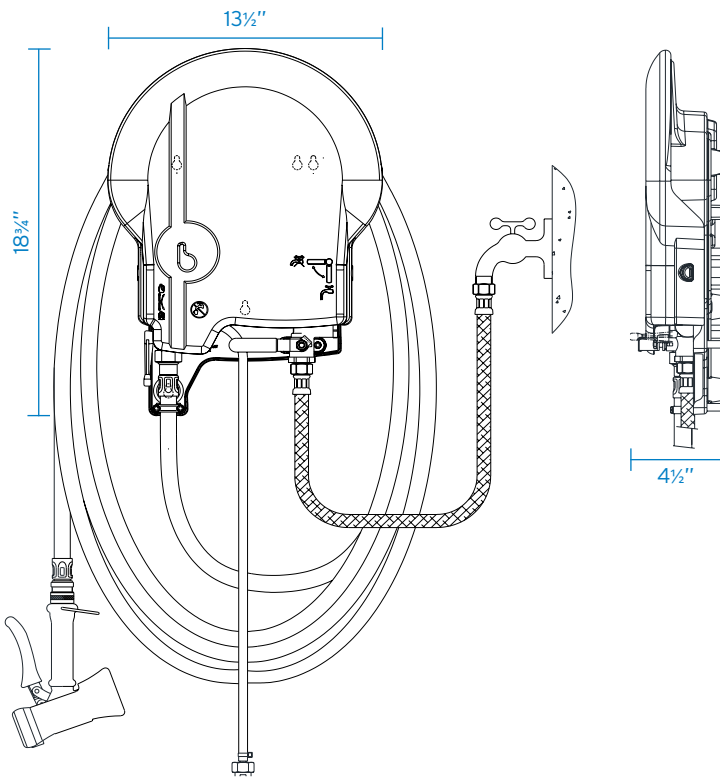

Dimensions

Width	13 1/2"
Height	18 3/4"
Depth	4 1/2"

Weight

Unit	5.7 lbs
------	---------

Part Numbers:

DSXXDC-XXM-X/U9

Base Unit

Hose

Spray Gun

Part Number	Description	Length	Description	Model	Description
DS30DC	EcoSpray Station 1 Chemical (DC)	10M	33' hose	D	Dinga Spray Gun
DS35DC	EcoSpray Station 2 Chemical (DC)	15M	50' hose	E	Ergo RB35 Spray Gun

Spare Parts

Part Number	Description
XSB2003/U9	33' hose
XSB2004/U9	50' hose
XSB2005/U9	Dinga Spray Gun
XSB2006/U9	Ergo RB35 Spray Gun

Part Number	Description
XSB2035/U9	Ergo RB65 Spray Gun
XSB2034/U9	Foam Wand Attachment

Shipping Info

Shipping Method	Quantity of Units	Dimensions L x W x H (in)	Net packed weight (lbs)
Unit	1	22" x 14" x 11 3/4"	21 lbs

T (+1) 913-956-4909 E sales@brightwell-inc.com W brightwell-inc.com

Brightwell Dispensers Inc. 9858 Britton Street, Lenexa, KS, 66219

All information in this data sheet is correct at the time of printing and is subject to change without notice.